

SPECIFICATION

MATERIAL:

Housing: PBT+30%G. F UL94V-0
 Contacts: Copper Alloy

ELECTRICAL:

Current rating: 2 Amps .
 Contact resistance: 20 mΩ initial
 Insulation resistance: 1000 MΩ min @ 500 VDC
 Dielectric withstanding voltage: 1000 VAC/minute
 Operating temperature: -55° C TO +125° C

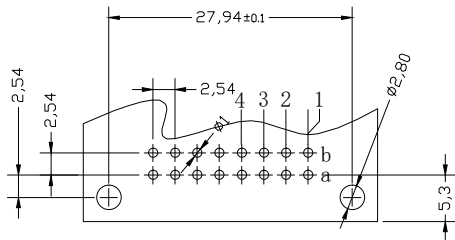
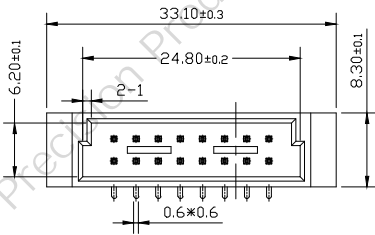
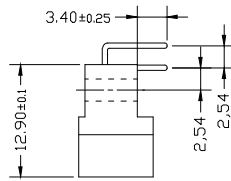
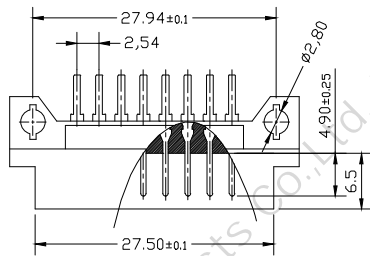

PCB LAYOUT(RECOMMENDED)
 (TOP VIEW TOL. :±0.05)

Pitch	Position	Rows with Contacts	Contact Arrange
2.54	16	A B	4 3 2 1 + + + + - - - - b a
	8	A -	4 3 2 1 + + + + - - - - b a
5.08	8	A B	4 3 2 1 + + + + - - - - b a
	4	A	4 3 2 1 + + + + - - - - b a

公差一览表 TOLERANCE UNLESS OTHERWISE			
X.	±0.25	X°.	±5°
.X	±0.20	.X°	±2°
.XX	±0.15	.XX°	±1°
.XXX	±0.02	.XXX°	±0.5°
日期 Date	2009. 04. 15		

欧式插座DIN 41612 216弯针公座

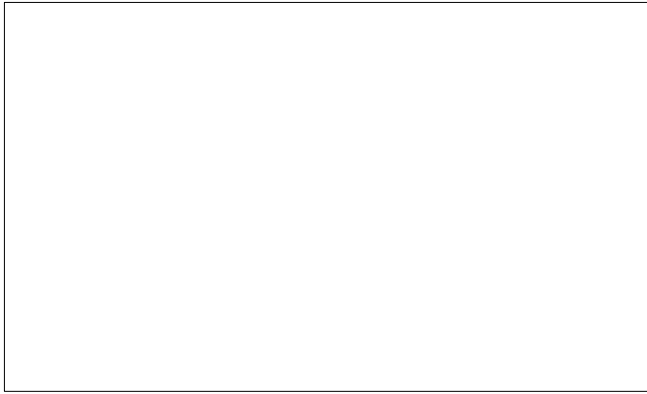

SPECIFICATION

MATERIAL:

Housing: PBT+30%G. F UL94V-0
 Contacts: Copper Alloy

ELECTRICAL:

Current rating: 2 Amps .
 Contact resistance: 20 mΩ initial
 Insulation resistance: 1000 MΩ min @ 500 VDC
 Dielectric withstanding voltage: 1000 VAC/minute
 Operating temperature: -55° C TO +125° C

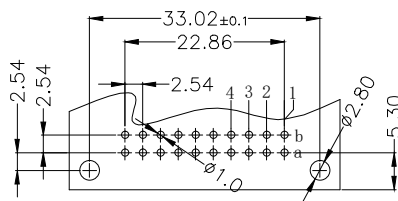
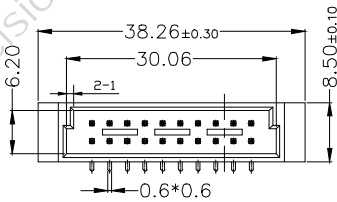
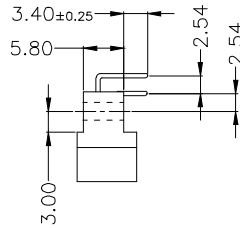
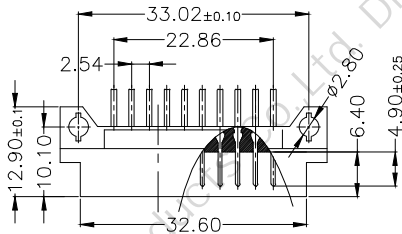

PCB LAYOUT(RECOMMENDED)
 (TOP VIEW TOL. :±0.05)

Pitch	Position	Rows with Contacts	Contact Arrange
2.54	20	A B	
	10	A -	
5.08	10	A B	
	5	A -	

公差一览表 TOLERANCE UNLESS OTHERWISE			
X.	±0.25	X°	±5°
.X	±0.20	.X°	±2°
.XX	±0.15	.XX°	±1°
.XXX	±0.02	.XXX°	±0.5°
日期 Date	2009. 04. 15		

欧式插座DIN 41612 220弯针公座

SPECIFICATION

MATERIAL:

Housing: PBT+30%G. F UL94V-0
 Contacts: Copper Alloy

ELECTRICAL:

Current rating: 2 Amps .
 Contact resistance: 20 mΩ initial
 Insulation resistance: 1000 MΩ min @ 500 VDC
 Dielectric withstanding voltage: 1000 VAC/minute
 Operating temperature: -55° C TO +125° C

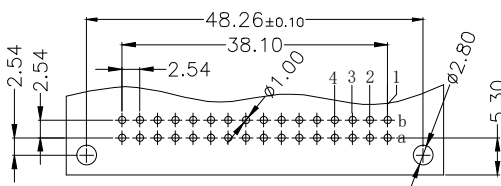
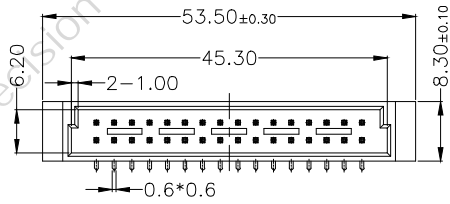
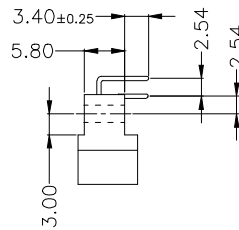
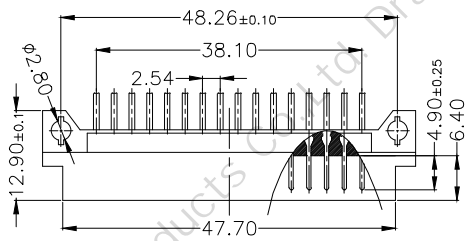

PCB LAYOUT (RECOMMENDED)
 (TOP VIEW TOL. : ±0.05)

Pitch	Position	Rows with Contacts	Contact Arrange
2.54	32	A B	
	16	A -	
5.08	16	A B	
	8	A -	

公差一览表 TOLERANCE UNLESS OTHERWISE			
X.	±0.25	X°	±5°
.X	±0.20	.X°	±2°
.XX	±0.15	.XX°	±1°
.XXX	±0.02	.XXX°	±0.5°
日期 Date	2009. 04. 15		

欧式插座DIN 41612 232弯针公座

SPECIFICATION

MATERIAL:

Housing: PBT+30%G. F UL94V-0
 Contacts: Copper Alloy

ELECTRICAL:

Current rating: 2 Amps .
 Contact resistance: 20 mΩ initial
 Insulation resistance: 1000 MΩ min @ 500 VDC
 Dielectric withstanding voltage: 1000 VAC/minute
 Operating temperature: -55° C TO +125° C

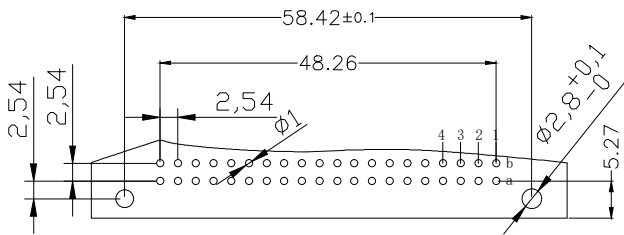
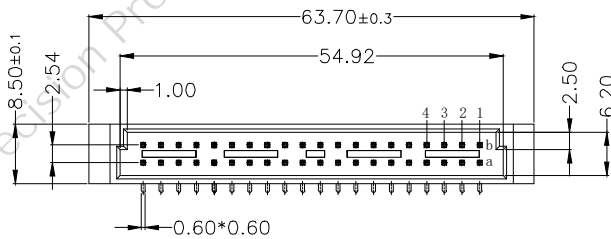
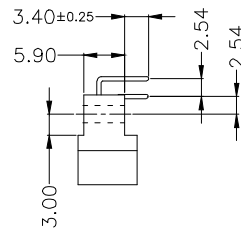
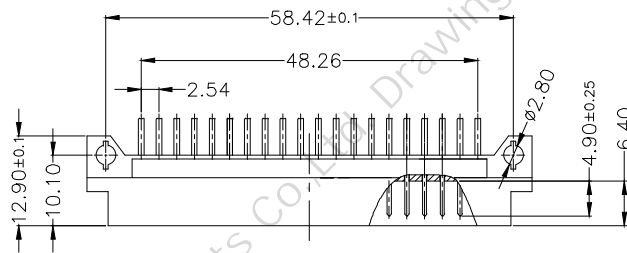

Pitch	Position	Rows with Contacts	Contact Arrange
2.54	40	A B	
	20	A -	
5.08	20	A B	
	10	A -	

PCB LAYOUT(RECOMMENDED)
 (TOP VIEW TOL. :±0.05)

公差一览表 TOLERANCE UNLESS OTHERWISE			
X.	±0.25	X°	±5°
.X	±0.20	.X°	±2°
.XX	±0.15	.XX°	±1°
.XXX	±0.02	.XXX°	±0.5°
日期 Date	2021-10-09		

欧式插座DIN 41612 240弯针公座

SPECIFICATION

MATERIAL:

Housing: PBT+30%G. F UL94V-0
 Contacts: Copper Alloy

ELECTRICAL:

Current rating: 2 Amps .
 Contact resistance: 20 mΩ initial
 Insulation resistance: 1000 MΩ min @ 500 VDC
 Dielectric withstanding voltage: 1000 VAC/minute
 Operating temperature: -55° C TO +125° C

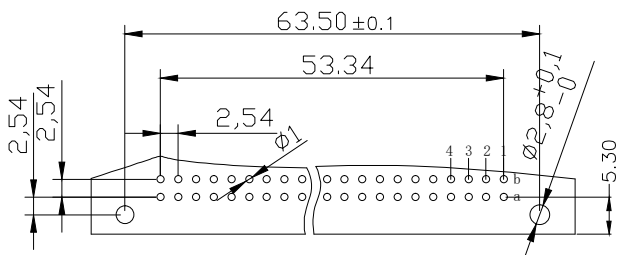
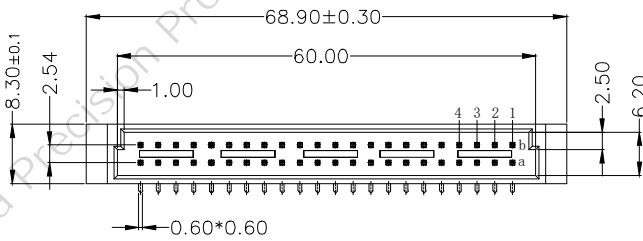
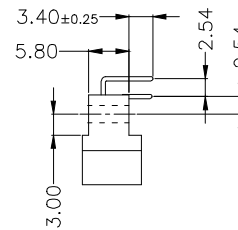
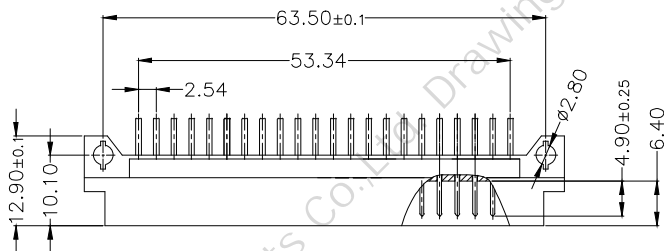

PCB LAYOUT(RECOMMENDED)
 (TOP VIEW TOL. :±0.05)

Pitch	Position	Rows with Contacts	Contact Arrange
2.54	44	A B	
	22	A -	
5.08	22	A B	
	11	A -	

公差一览表 TOLERANCE UNLESS OTHERWISE			
X.	±0.25	X°.	±5°
.X	±0.20	.X°	±2°
.XX	±0.15	.XX°	±1°
.XXX	±0.02	.XXX°	±0.5°
日期 Date	2009. 04. 15		

欧式插座DIN 41612 244弯针公座

SPECIFICATION

MATERIAL:

Housing: PBT+30%G. F UL94V-0
 Contacts: Copper Alloy

ELECTRICAL:

Current rating: 2 Amps .
 Contact resistance: 20 mΩ initial
 Insulation resistance: 1000 MΩ min @ 500 VDC
 Dielectric withstanding voltage: 1000 VAC/minute
 Operating temperature: -55° C TO +125° C

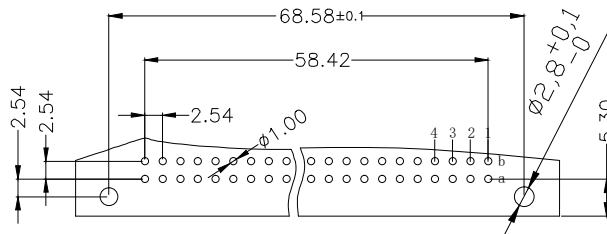
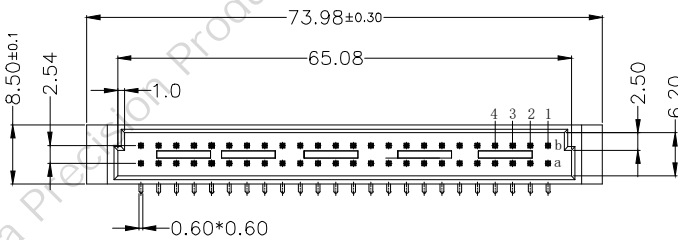
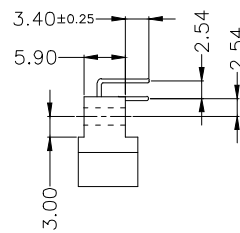
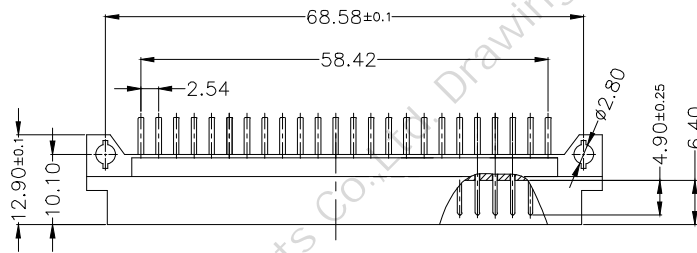

Pitch	Position	Rows with Contacts	Contact Arrange
2.54	48	A B	4 3 2 1 a b
	24	A -	4 3 2 1 a b
5.08	24	A B	4 3 2 1 a b
	12	A -	4 3 2 1 a b

PCB LAYOUT(RECOMMENDED)

(TOP VIEW TOL. :±0.05)

公差一览表 TOLERANCE UNLESS OTHERWISE			
X.	±0.25	X°	±5°
.X	±0.20	.X°	±2°
.XX	±0.15	.XX°	±1°
.XXX	±0.02	.XXX°	±0.5°
日期 Date	2009. 04. 15		

欧式插座DIN 41612 248弯针公座

SPECIFICATION

MATERIAL:

Housing: PBT+30%G. F UL94V-0
 Contacts: Copper Alloy

ELECTRICAL:

Current rating: 2 Amps .
 Contact resistance: 20 mΩ initial
 Insulation resistance: 1000 MΩ min @ 500 VDC
 Dielectric withstanding voltage: 1000 VAC/minute
 Operating temperature: -55° C TO +125° C

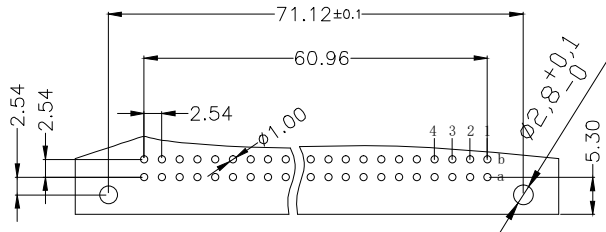
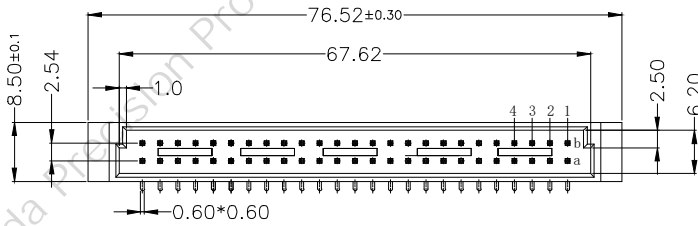
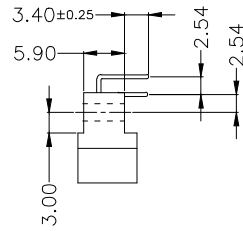
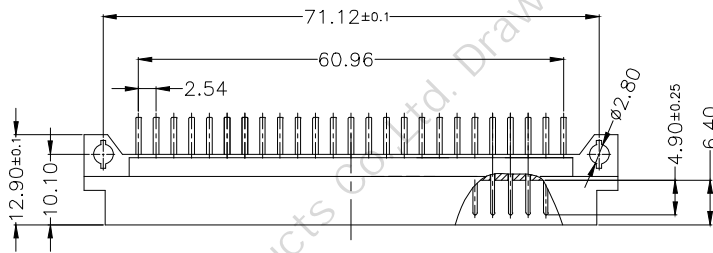

Pitch	Position	Rows with Contacts	Contact Arrange
2.54	50	A B	4 3 2 1 a b
	25	A -	4 3 2 1 a b
5.08	26	A B	4 3 2 1 a b
	13	A -	4 3 2 1 a b

PCB LAYOUT(RECOMMENDED)

(TOP VIEW TOL. :±0.05)

公差一览表 TOLERANCE UNLESS OTHERWISE			
X.	±0.25	X°	±5°
.X	±0.20	.X°	±2°
.XX	±0.15	.XX°	±1°
.XXX	±0.02	.XXX°	±0.5°
日期 Date	2009. 04. 15		

欧式插座DIN 41612 250弯针公座

SPECIFICATION

MATERIAL:

Housing: PBT+30%G. F UL94V-0
 Contacts: Copper Alloy

ELECTRICAL:

Current rating: 2 Amps .
 Contact resistance: 20 mΩ initial
 Insulation resistance: 1000 MΩ min @ 500 VDC
 Dielectric withstanding voltage: 1000 VAC/minute
 Operating temperature: -55° C TO +125° C

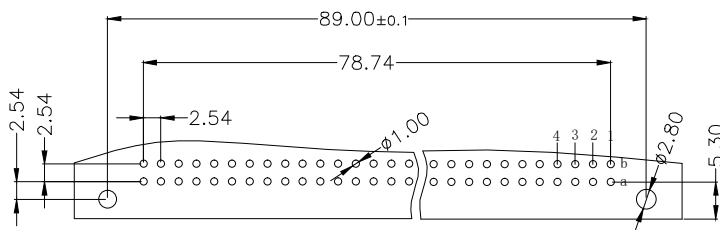
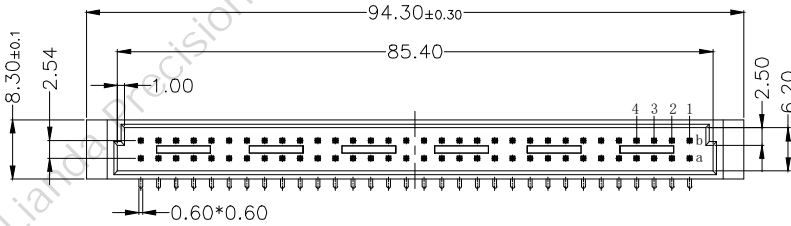
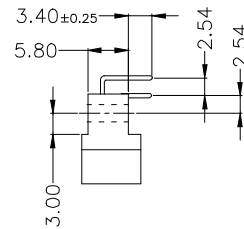
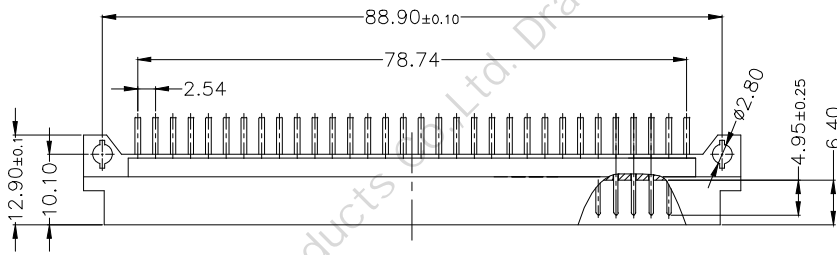
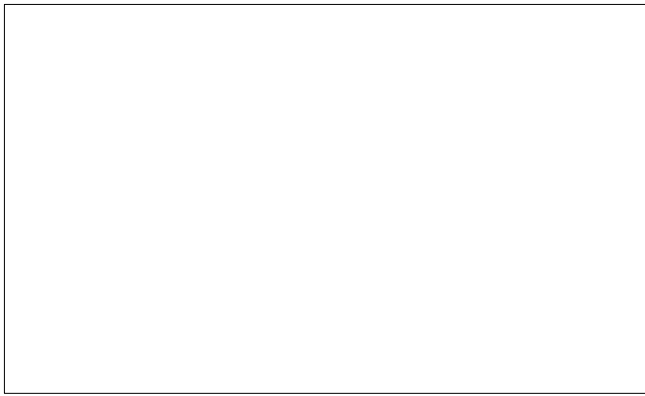

Pitch	Position	Rows with Contacts	Contact Arrange
2.54	64	A B	4 3 2 1 + + + + -b -a
	32	A -	4 3 2 1 + + + + -b -a
5.08	32	A B	4 3 2 1 + + + + -b -a
	16	A -	4 3 2 1 + + + + -b -a

PCB LAYOUT(RECOMMENDED)
 (TOP VIEW TOL. :±0.05)

公差一览表 TOLERANCE UNLESS OTHERWISE			
X.	±0.25	X°.	±5°
.X	±0.20	.X°	±2°
.XX	±0.15	.XX°	±1°
.XXX	±0.02	.XXX°	±0.5°
日期 Date	2009. 04. 15		

欧式插座DIN 41612 264弯针公座