

# T1502 SERIES 1.50mm pitch Through Hole Reflow Type Connector

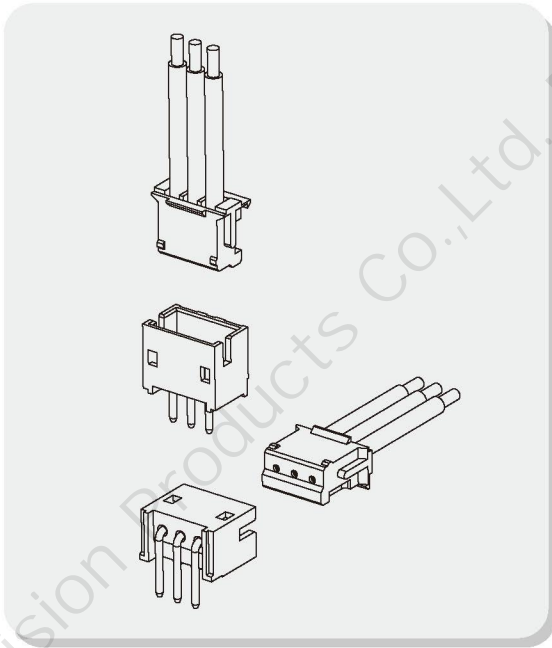

## ■ Specifications

- Contact resistance:  $\leq 20\text{m}\Omega$
- Insulation resistance:  $\geq 500\text{M}\Omega$
- Rated voltage: 125V AC DC
- Rated current: 1.0A AC DC
- Withstand voltage: 500V AC/minute
- Temperature range:  $-25^{\circ}\text{C} \sim +105^{\circ}\text{C}$

## ■ Assembly Layout

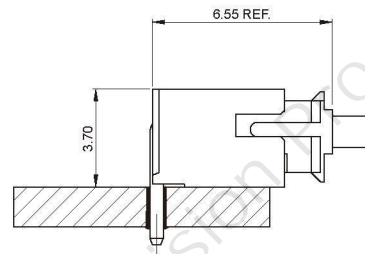
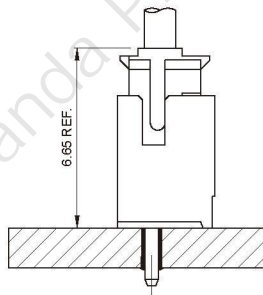

WIRE TO BOARD

BOARD TO BOARD

WIRE TO WIRE

FPC SERIES

THR SERIES

LIGHTING SERIES

OTHER SERIES

# T1502 SERIES 1.50mm pitch Through Hole Reflow Type Connector

## T1502A (1.50mm pitch 180°Wafer DIP TYPE)

- Reference Information:
- Material: Pin: Brass/Tin-plated
- Wafer: LCP,UL94V-0
- Mates with A1501 series Housing

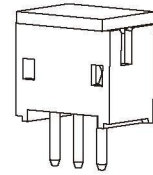

### Ordering Information & Dimensions:

Circuit	Dimensions(mm)	
	A	B
02	1.50	4.50
03	3.00	6.00
04	4.50	7.50
05	6.00	9.00
06	7.50	10.50
07	9.00	12.00
08	10.50	13.50
09	12.00	15.00
10	13.50	16.50
11	15.00	18.00
12	16.50	19.50
13	18.00	21.00
14	19.50	22.50
15	21.00	24.00
16	22.50	25.50

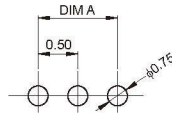
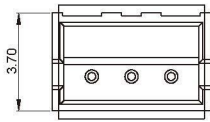

P.C.B LAYOUT

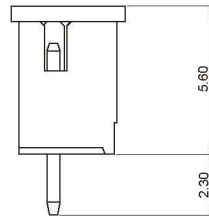
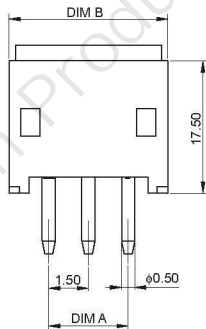

## T1502AW (1.50mm pitch 90°Wafer DIP TYPE)

- Reference Information:
- Material: Pin: Brass/Tin-plated
- Wafer: LCP,UL94V-0
- Mates with A1501 series Housing

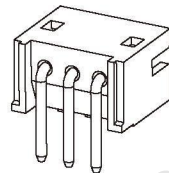

### Ordering Information & Dimensions:

Circuit	Dimensions(mm)	
	A	B
02	1.50	4.50
03	3.00	6.00
04	4.50	7.50
05	6.00	9.00
06	7.50	10.50
07	9.00	12.00
08	10.50	13.50
09	12.00	15.00
10	13.50	16.50
11	15.00	18.00
12	16.50	19.50
13	18.00	21.00
14	19.50	22.50
15	21.00	24.00
16	22.50	25.50

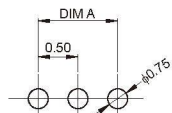
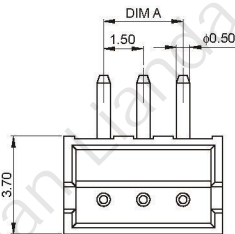

P.C.B LAYOUT

