

HSE ROHS

REV	EXI NO	DESCRIPTION	DATE	NAME
1		NEW		

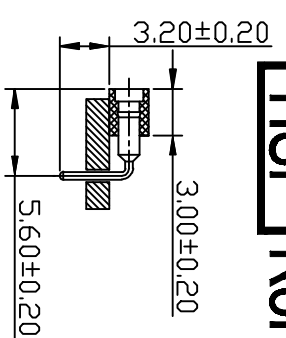

Technical Specs:
 Insulator: Black glass filled polyester PPS-GF30-FFR
 Flammability: UL 94V-0
 Sleeve: Brass (C3604)
 Contact clip(4 finger): Beryllium copper(C1720)
 Accepted pin: Ø0.38 to 0.64mm
 Forces: (polished steel gauge Ø0.43mm)
 -Insertion 2 N typ
 -Withdrawal 1 N typ
 Mechanical life: min500 cycles
 Rated current: 3A
 Contact resistance: max 10mΩ
 Dielectric resistance: Min 1000V RMS
 Coplanarity SMD max 0.1 mm(measured on terminations:
 25 mm long connectors)

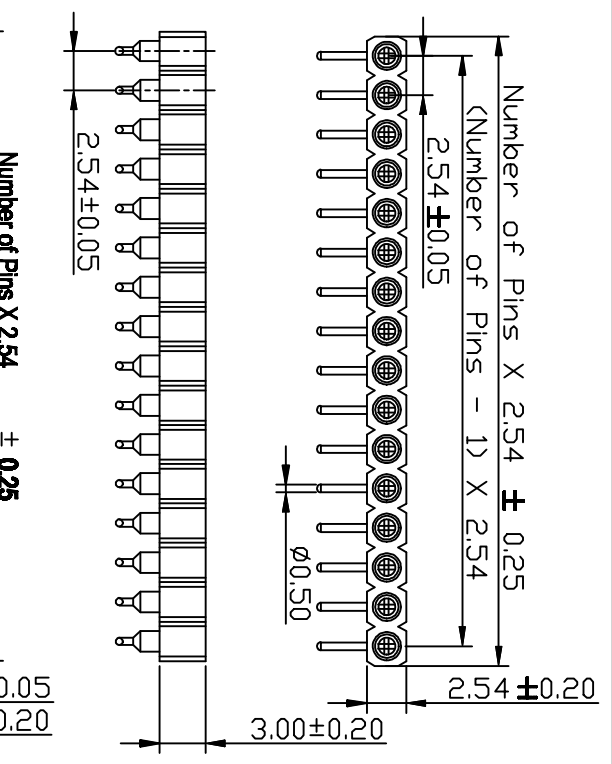
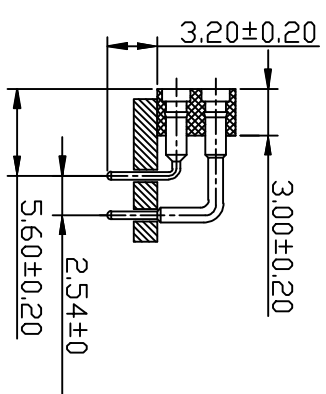
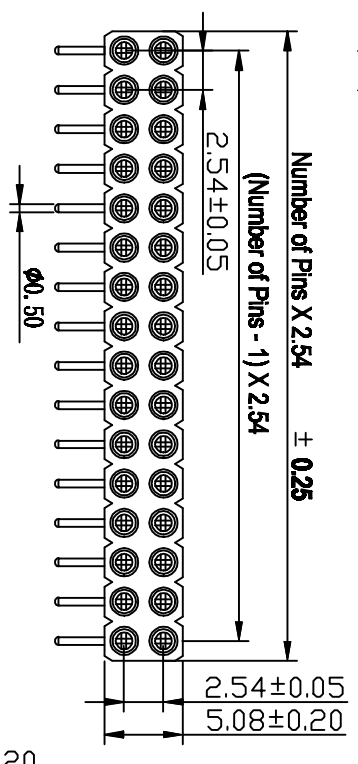

Ordering Information

L488XX - X X XX X

NO. of Pins
 Part Row:
 01-40P

The connection

Contact Plating
 1=Gold flash
 2=Au/Tin
 3=TiIn

Serial NO.
 01-99

Packing
 A=PE Bag
 B=Tube
 C=Tray
 D=Reel

method
 0=180°
 1=90°
 2=SMT

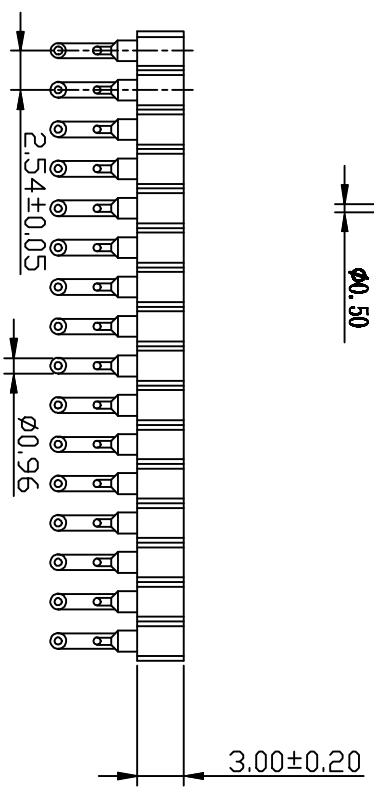

STANDARD TOLERANCE (EXCEPT SPECIFIED)	ANGLES
LINER 0 ±0.30	0° ±3°
0 ±0.20	±2°
0.00 ±0.10	±1°

LDCONN 东莞连大精密制品有限公司		Dongguan Lianda Precision Products Co., LTD	
TITLE	DRAWN BY	Lu Junhui	18.11.10
PART NO	CHECKED BY		
DRAWING NO	APPROVED BY		
SCALE	UNIT	PAGE	SIZE
1:1	mm	1/1	A4