

HSE ROHS

REV	REV NO	DESCRIPTION	DATE	NAME
1		NEW		

2.00*No.of Positions±0.25

2.00*No.of Positions-2.00

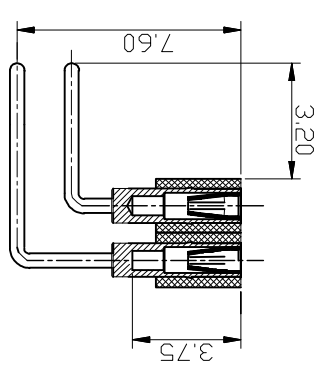
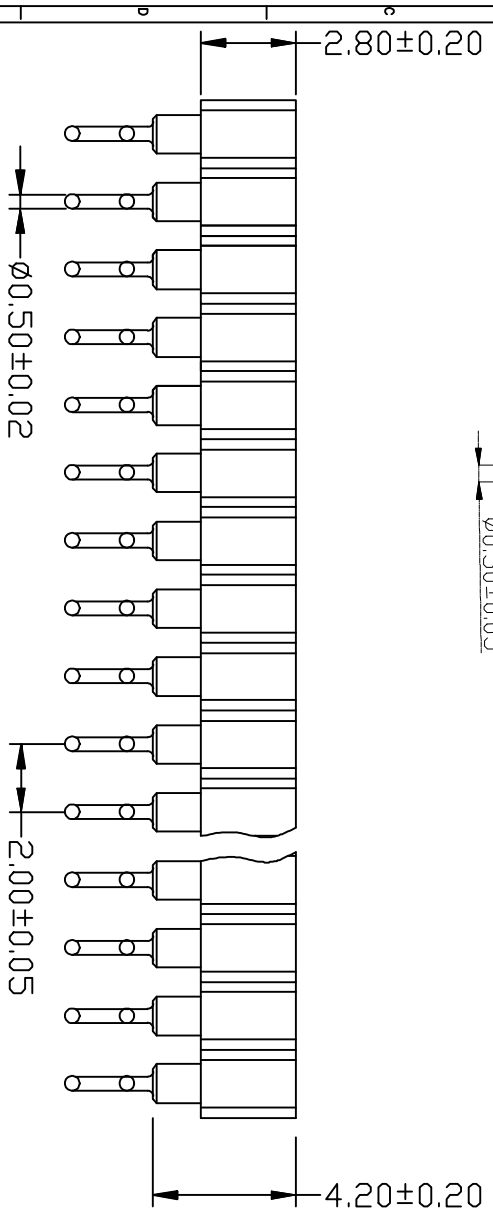
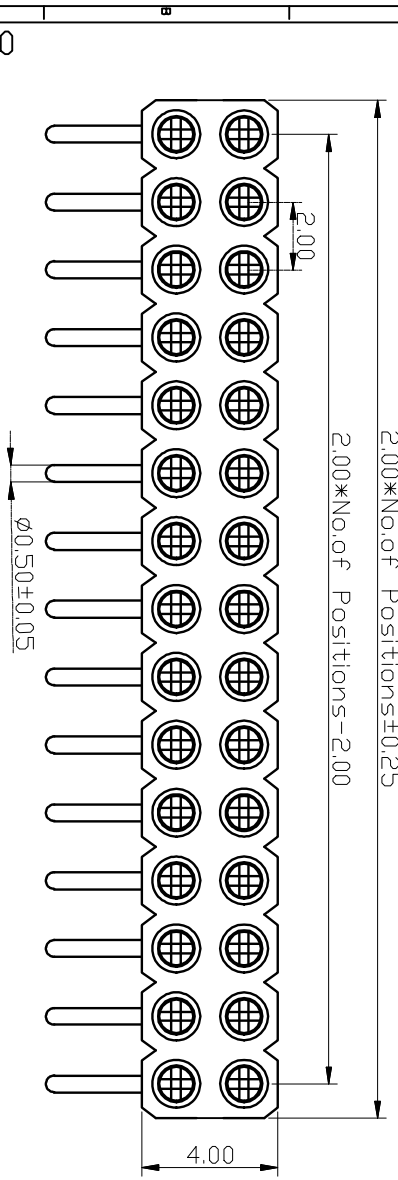

Masterials
 Pin (outer sleeve) :Brass,machined, CuZn39Pb2
 Clip(contact 4 finger) :Beryllium copper,heat treated
 Plating(outer sleeve) :
 Tin plated : 2u"m/80u"nickel,5um/200u"Tin
 Gold plated: 2u"m/80u"nickel,full gold
 Plating clip(contact):
 2um/80 u"nickel,gold or tin plating
 Insulator body(backend) : Glass filled thermoplastic polyester UL94V-0 electrical
 Current rating : 3 Amps/contact max.
 Contact resistance : 10m Ω/contact
 Insulation resistance : 1000M at V=100V
 Operating voltage : 60 AC/DC

Ordering Information

L488XX - X X XX X

NO. of Pins
 Per Row:
 01-40P

The connection method
 0=180°
 1=90°
 2-SMT

Contact Plating
 1=Gold flash
 2=Au/Tin
 3=TiIn

Serial NO. 01-99

Packing
 A=PE Bag
 B=Tube
 C=Tray
 D=Reel

STANDARD TOLERANCE (EXCEPT SPECIFIED)	ANGLES
LINER	0.° ±3°
.0 ±0.30	.0° ±2°
.00 ±0.20	.00° ±1°
.000 ±0.10	

LDCONN 东莞连大精密制品有限公司 Dongguan Lianda Precision Products Co., LTD		The Rev. 1: Insulation Finish Number Pad 8: Insulation Type	
TITLE	DRAWN BY	DATE	NAME
PART NO	CHECKED BY		
DRAWING NO	APPROVED BY		
SCALE	UNIT	PAGE	SIZE
1:1	mm	1/1	A4