

HSE ROHS

| REV | ECN NO | DESCRIPTION | DATE | NAME |
|-----|--------|-------------|------|------|
| A | | NEW | | |

Note:

- Material
 - 1.1: Housing: LCP UL94-V0 Color:Black.
 - 1.2: Actuator: LCP UL94-V0 Color:Nature.
 - 1.3: Contact: Phosphor Bronze.
 - 1.4: LEG: Phosphor Bronze.
- Plating
 - 2.1: Contact: Tin.
 - 2.2: LEG: Tin
- Rating:
 - 3.1: Operating Voltage: 50V AC/DC.
 - 3.2: Current Rating: 0.2A AC/DC.
 - 3.3: Operating Temperature: -25°C~+85°C.
 - 3.4: Contact Resistance: 30 mΩ max.
 - 3.5: Insulation Resistance: 100 MΩ min.
 - 3.6: Dielectric withstanding Voltage: AC 200V
- Part Number:

| Number of Contacts | Dimension | | | |
|--------------------|-----------|-------|-------|-------|
| | A | B | C | D |
| 13 | 3.60 | 4.30 | 5.40 | 3.00 |
| 15 | 4.20 | 4.90 | 6.00 | 3.60 |
| 17 | 4.80 | 5.50 | 6.60 | 4.20 |
| 19 | 5.40 | 6.10 | 7.20 | 4.80 |
| 21 | 6.00 | 6.70 | 7.80 | 5.40 |
| 23 | 6.60 | 7.30 | 8.40 | 6.00 |
| 25 | 7.20 | 7.90 | 9.00 | 6.60 |
| 27 | 7.80 | 8.50 | 9.60 | 7.20 |
| 29 | 8.40 | 9.10 | 10.20 | 7.80 |
| 31 | 9.00 | 9.70 | 10.80 | 8.40 |
| 33 | 9.60 | 10.30 | 11.40 | 9.00 |
| 35 | 10.20 | 10.90 | 12.00 | 9.60 |
| 37 | 10.80 | 11.50 | 12.60 | 10.20 |
| 39 | 11.40 | 12.10 | 13.20 | 10.80 |
| 41 | 12.00 | 12.70 | 13.80 | 11.40 |
| 45 | 13.20 | 13.90 | 15.00 | 12.60 |
| 49 | 14.40 | 15.10 | 16.20 | 13.80 |
| 51 | 15.00 | 15.70 | 16.80 | 14.40 |
| 57 | 16.80 | 17.50 | 18.60 | 16.20 |
| 61 | 18.00 | 18.70 | 19.80 | 17.40 |
| 67 | 19.80 | 20.50 | 21.60 | 19.20 |
| 71 | 21.00 | 21.70 | 22.80 | 20.40 |

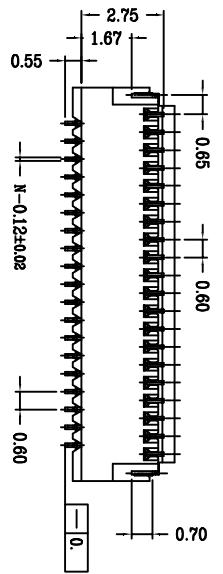
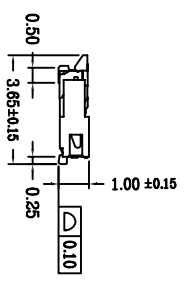
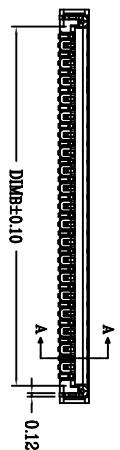
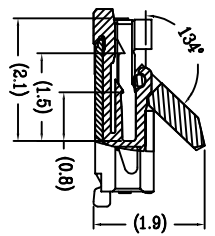
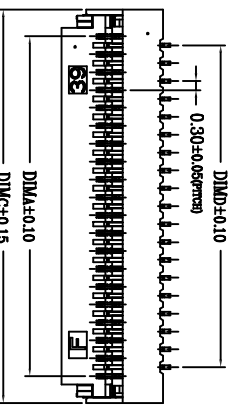

Ordering Information

L500XX-2

Ordering Information

1=SNIT Insulation Height I=1.0mm

2=Bottom Contact With Cover Lock

Contact Type

Pin

Packing B=Tube D=Reel

Serial No. 01-99

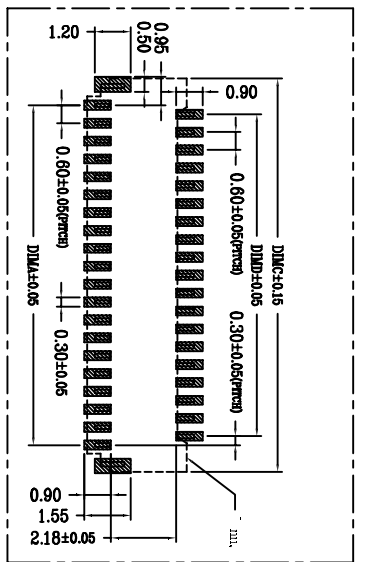
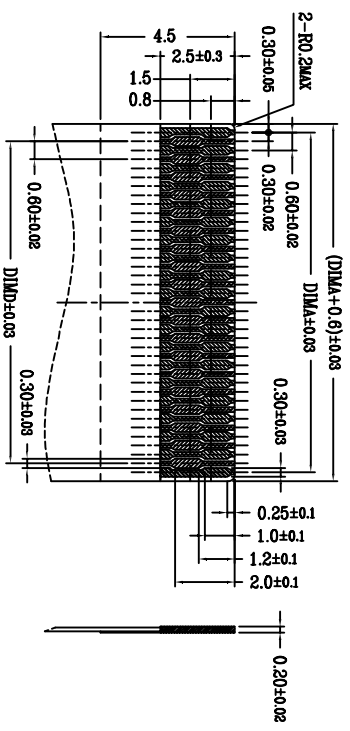

| STANDARD TOLERANCE (EXCEPT SPECIFIED) | | ANGLES | |
|---------------------------------------|-------|--------|-----|
| LINER | | | |
| .0 | ±0.30 | 0.° | ±3° |
| .00 | ±0.20 | .0° | ±2° |
| .000 | ±0.10 | .00° | ±1° |

| | | | |
|---------------------------------------------------------------------------|----------------------------------------------------------------|-------------|-----|
| LDCONN 东莞连大精密制品有限公司 Dongguan LianDa Precision Products Co., LTD | | | |
| TITLE | P010_3mm PFC Horizontal SNIT Down Contact Type With Cover Lock | DRAWN BY | WZG |
| PART NO | L500XX-211XXX | CHECKED BY | |
| DRAWING NO | | APPROVED BY | |
| SCALE | 1:1 | UNITE | mm |
| | | PAGE | 1/1 |
| | | SIZE | A4 |